

## BMM Fairlead blocks

Galvanized

Part no.	A	B	B <sub>1</sub>	D	E	G	J	S	Weight
	mm	mm	mm	mm	mm	mm	mm	mm	kg
KL130	235	100	100	130	100	85	10	110	10.9
KL170	300	100	100	170	130	125	10	115	20.4
KL215	340	100	100	215	117	164	10	130	27.0
KL230	390	120	120	230	135	175	12	140	43.5
KL300	475	120	120	300	155	240	12	180	53.8
KL370-1	615	140	140	370	220	285	12	210	86.7
* KL400-2	660	180	180	400	230	300	15	225	118.0
* KL500-2	770	180	180	500	255	380	20	265	213.0
* KL600-2	895	180	185	600	280	480	20	330	309.0
* KL650-2	960	245	240	650	305	500	20	330	415.0
KL800-2	1095	245	240	800	315	600	25	500	590

KL370-1 is only available with ball bearing.

\* Are only available with rollerbearing.

BMM-Blocks must be ordered with one of the following:

- 1 Ball bearing, greaseable.
- 0 Bronze bushing, greaseable.

On order add letter, e.g. KL130-1

Against extra charge all blocks are available with:

- H Flame hardened sheave.

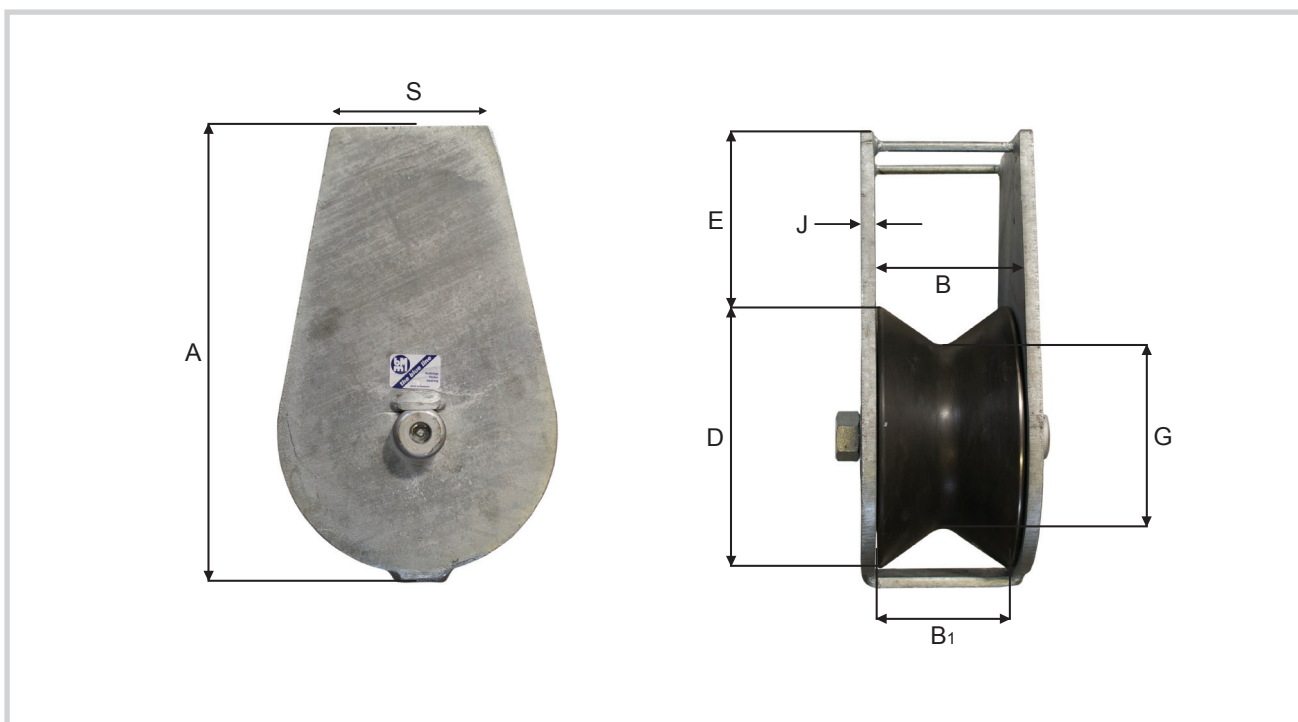

## Sheaves

### Ball bearing / roller bearing

Part no.	B	D	R	S	Weight
	mm	mm	mm	mm	kg
SK130-1	100	130	60	25	5.50
SK170-1	100	170	60	25	11.70
SK215-1	100	215	80	35	18.30
SK230-1	120	230	80	35	19.50
SK300-1	120	300	80	35	29.80
SK370-1	140	370	100	45	50.50
SK400-2	180	400	140	60	85.00
SK500-2	180	500	170	70	130.00
SK600-2	180	600	170	70	150.00
SK650-2	240	650	170	70	240.00

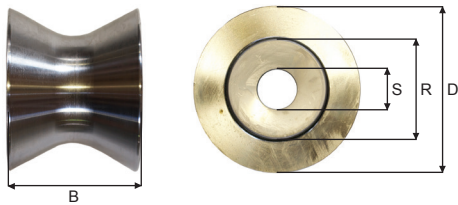

### Bronze bushing

Part no.	B	D	R	S	Weight
	mm	mm	mm	mm	kg
SK130-0	100	130	37	25	5.50
SK170-0	100	170	37	25	12.00
SK215-0	100	215	56	35	18.00
SK230-0	120	230	56	38	20.10
SK300-0	120	300	56	38	30.70

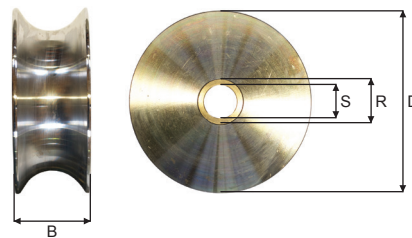

## Pins

### Ball bearing

Part no.	X	Y	Z	Weight
	mm	mm	mm	kg
PK130-1	155	25	123	0.70
PK170-1	155	25	123	0.70
PK215-1	158	35	117	1.30
PK230-1	190	35	133	1.50
PK300-1	190	35	133	1.50
PK370-1	234	45	152	3.20

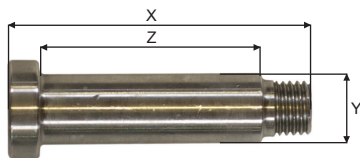

### Bronze bushing

Part no.	X	Y	Z	Weight
	mm	mm	mm	kg
PK130-0	155	25	123	0.70
PK170-0	155	25	123	0.70
PK215-0	158	35	117	1.30
PK230-0	190	38	133	1.60
PK300-0	190	38	165	1.60

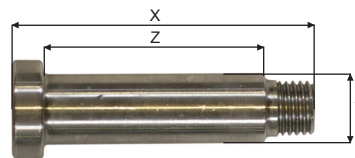

### Roller bearing

Part no.	X	Y	Z	Weight
	mm	mm	mm	kg
PK400-2	330	60	212	10.90
PK500-2	340	70	225	12.90
PK600-2	340	70	225	12.90
PK650-2	404	70	285	14.60

