

## BMM Blocks · Single

Galvanized

Part no.	WLL 5:1 ton	Max load on headfitting ton	Test load ton	A mm	B mm	D mm	Becket dia. (extra charge) mm	Max wire mm	Weight kg
KT1	1.0	2.0	4.0	163	22	80	16	16	1.7
KT2	2.0	4.0	8.0	195	24	110	22	18	3.1
KT3	3.0	6.0	12.0	257	28	150	31	20	6.4
KT4	4.0	8.0	16.0	330	35	185	40	22	11.1
KT6	6.0	12.0	24.0	365	42	210	40	24	17.0

BMM-Blocks must be ordered with one of the following:

- 2 Roller bearings, KT3 greaseable roller bearings
- 1 Ball bearing; KT1, KT2 sealed ball bearings; KT4, KT6 greaseable ball bearings.
- 0 Bronze bushing; All bronze bushing are greaseable.

And one of the following:

- E Swivel eye.
- K Swivel hook. If the block is used with hook as suspension, the WLL is reduced with 50%.
- F Swivel fork, KT4, KT6.
- S Swivel shackle eye, KT4, KT6

On order add letter, e.g. KT2-1EG

Against extra charge all blocks are available with:

- B Becket.
- C Tested with certificate.
- H Flame hardend sheave.

On order add letter, e.g. KT2-1EGC

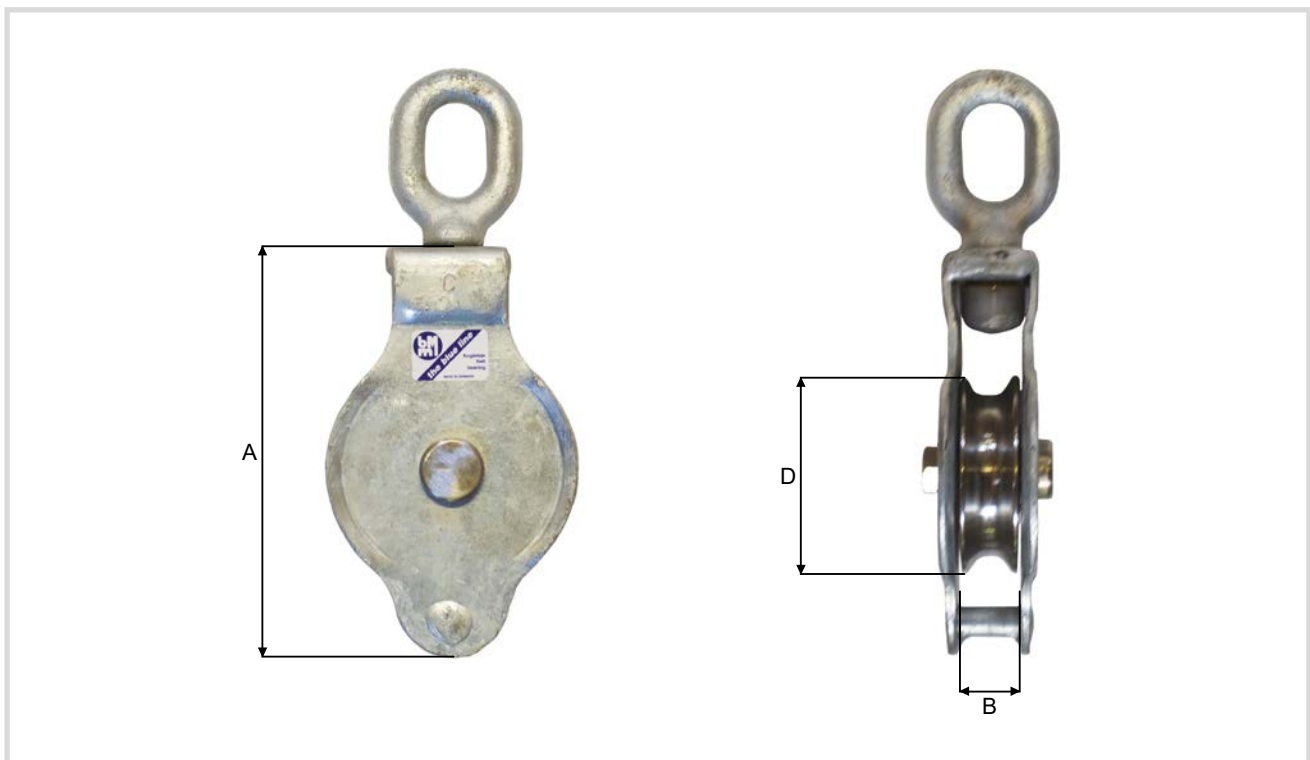

## Top fittings

Part no.	Swivel eye				Swivel hook			Swivel shackle eye				Swivel fork					
	M mm	N mm	O mm	P mm	O mm	P mm	Q mm	L mm	M mm	R mm	P mm	K mm	L mm	M mm	N mm	R mm	P mm
KT1	25	38	13	65	20	82	25	-	-	-	-	-	-	-	-	-	-
KT2	23	55	16	94	25	94	28	-	-	-	-	-	-	-	-	-	-
KT3	26	66	20	110	30	105	30	-	-	-	-	-	-	-	-	-	-
KT4	35	68	23	134	38	132	38	29	42	35	93	104	23	40	65	30	134
KT6	40	90	26	153	46	170	46	33	46	42	104	104	23	40	65	30	134

## Sheaves

### Ball bearing

Part no.	B mm	D mm	R mm	S mm	Weight kg
SKT1-1	22	80	47	17	0.60
SKT2-1	24	110	52	20	1.25
SKT3-2	28	150	47	25	2.65
SKT4-1	35	185	62	30	5.10
SKT6-1	42	210	76	30	7.70

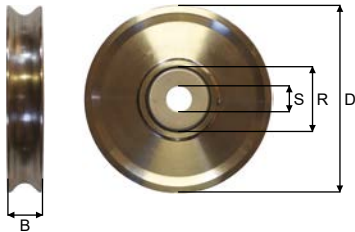

### Bronze Bushing

Part no.	B mm	D mm	S mm	Weight kg
SKT1-0	22	80	20	0.75
SKT2-0	24	110	25	1.30
SKT3-0	28	150	25	2.60
SKT4-0	35	185	30	5.20
SKT6-0	42	210	30	7.60

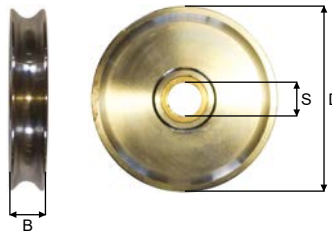

## Pins

### Ball bearing

Part no.	X mm	Y mm	Z mm	Weight kg
PKT1-1	50	17	28	0.10
PKT2-1	52	20	30	0.15
PKT3-2	67	25	36	0.20
PKT4-1	75	30	43	0.40
PKT6-1	85	30	51	0.45

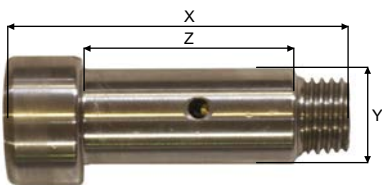

### Bronze Bushing

Part no.	X mm	Y mm	Z mm	Weight kg
PKT1-0	57	20	28	0.10
PKT2-0	61	25	30	0.15
PKT3-0	67	25	35	0.20
PKT4-0	75	30	43	0.40
PKT6-0	85	30	51	0.45

