

Closed end terminals - stainless steel

Part no.	Size	A	B	C	D	E	F	Dia.	Dia. after pressing	Weight	Swaging die	Required pressure
	mm	mm	mm	mm	mm	mm	mm	mm	mm	kg		ton
NE10/SS	10	20	53	130	10.5	41	68	25.7	22	0.4	DIE-NE-22	150
NE12/SS	12	20	53	130	12.5	41	68	25.7	22	0.4	DIE-NE-22	150
NE14/SS	14	36	70	200	14.5	50	96	32.0	28	1.20	DIE-NE-28	250

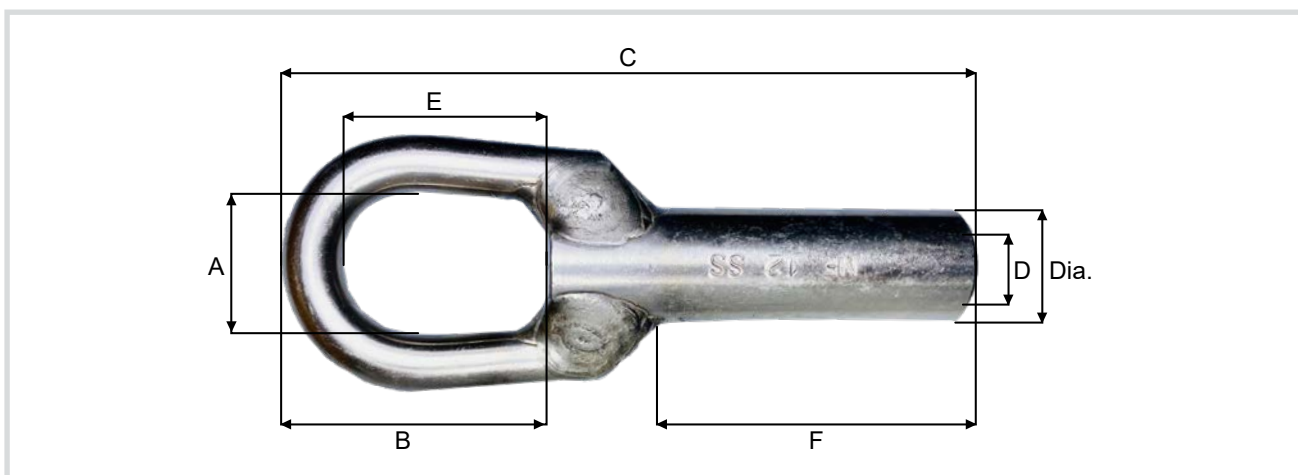

Terminals for connectors - stainless steel

Part no.	A	A ₁	B	C	D	F	G	Dia.	For connector	Dia. after pressing	Weight	Swaging dies	Required pressure
	mm	mm	mm	mm	mm	mm	mm	mm	no	mm	kg		ton
NE14C/SS	26.5	26.5	48	106	14.5	58	26	32	13	28	0.6	DIE-NE-28	250
NE16C/SS	26.5	26.5	48	106	16.5	60	26	32	13	28	0.6	DIE-NE-28	250
NE18C/SS	29.0	34.0	60	133	18.5	69	34	41	16/19	36	1.2	DIE-NE-36	300
NE20C/SS	29.0	34.0	60	141	20.5	78	34	41	16/19	36	1.2	DIE-NE-36	300

